

Magnetic Lighting  
Solutions Gen2

# Magnetic Lighting Solutions Gen2

Linear Diffused F



## Linear Diffused F Module

**LEDOS**  
LIGHTING SOLUTIONS

# Magnetic Lighting Solutions Gen2

Linear Diffused F



Linear Diffused F - 350	
CRI	Ra90
Size	348 x 11 x 8.9mm
LUMEN	60lm/W
Material	Aluminum + Polycarbonate
Power	6W
CCT	2700K   3000K   4000K   6000K

CB TÜV



Linear Diffused F - 575	
CRI	Ra90
Size	576 x 11 x 8.9mm
LUMEN	70lm/W
Material	Aluminum + Polycarbonate
Power	12W
CCT	2700K   3000K   4000K   6000K

CB TÜV

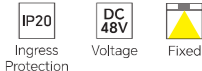

FIXTURE COLOR  BK  WH

OPTIONS  
1 NON-DIM

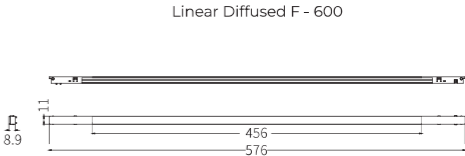
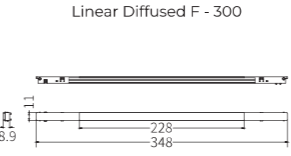

# Magnetic Lighting Solutions Gen2

LinearBlade F



## LinearBlade F Module

# LEDOS

LIGHTING SOLUTIONS

# Magnetic Lighting Solutions Gen2

LinearBlade F



### LinearBlade F - 350

CRI	Ra90
Size	348 x 11 x 8.9mm
LUMEN	70lm/W
Material	Aluminum + Polycarbonate
Power	6W
CCT	2700K   3000K   4000K   6000K
Beam	40°

CB TÜV



### LinearBlade F - 575

CRI	Ra90
Size	576 x 11 x 8.9mm
LUMEN	80lm/W
Material	Aluminum + Polycarbonate
Power	12W
CCT	2700K   3000K   4000K   6000K
Beam	40°

CB TÜV



FIXTURE COLOR  BK  WH

#### OPTIONS

1 NON-DIM

LinearBlade F - 300

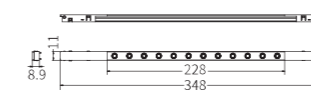

LinearBlade F - 600

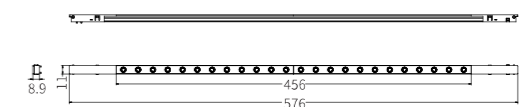

# Magnetic Lighting Solutions Gen2

LinearBlade Stick R



## LinearBlade Stick R Module

**LEDOS**  
LIGHTING SOLUTIONS

# Magnetic Lighting Solutions Gen2

LinearBlade Stick R



### LinearBlade Stick R - 250

<b>CRI</b>	Ra90
<b>Size</b>	235.5 x 11 x 25.6mm
<b>LUMEN</b>	70lm/W
<b>Material</b>	Aluminum
<b>Power</b>	10W
<b>CCT</b>	2700K   3000K   4000K   6000K
<b>Beam</b>	36°

CB TÜV



**FIXTURE COLOR** ■ BK □ WH

#### OPTIONS

- 1 NON-DIM
- 2 0/1-10V
- 3 DALI
- 4 ZIGBEE

CASAMBI

### LinearBlade Stick R - 300

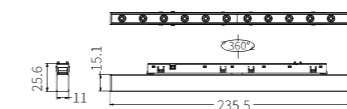

Magnetic Lighting Solutions Gen2

LinearBlade Stick RA



LinearBlade Stick RA Module



Magnetic Lighting Solutions Gen2  
LinearBlade Stick RA



**LinearBlade Stick RA - 250**

<b>CRI</b>	Ra90
<b>Size</b>	230.7 x 15.7 x 66.9mm
<b>LUMEN</b>	70lm/W
<b>Material</b>	Aluminum
<b>Power</b>	12W
<b>CCT</b>	2700K   3000K   4000K   6000K
<b>Beam</b>	24°

CB TÜV



FIXTURE COLOR  BK  WH

- OPTIONS**
- 1 NON-DIM
  - 2 0/1-10V
  - 3 DALI
  - 4 ZIGBEE

CASAMBI

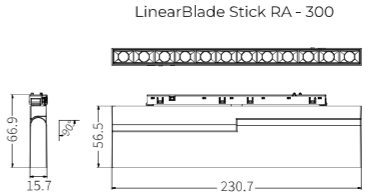

# Magnetic Lighting Solutions Gen2

Track Cylinder



## Track Cylinder Module

**LEDOS**  
LIGHTING SOLUTIONS

# Magnetic Lighting Solutions Gen2

Track Cylinder



Track Cylinder - D16	
CRI	Ra90
Size	Ø16 x 80mm
LUMEN	70lm/W
Material	Aluminum
Power	3W
CCT	2700K   3000K   4000K   6000K
Beam	24°   36°   60°

CB TÜV



Track Cylinder - D20	
CRI	Ra90
Size	Ø20 x 100mm
LUMEN	75lm/W
Material	Aluminum
Power	5W
CCT	2700K   3000K   4000K   6000K
Beam	15°   24°   36°

CB TÜV



Track Cylinder - D30	
CRI	Ra90
Size	Ø30 x 120mm
LUMEN	85lm/W
Material	Aluminum
Power	9W
CCT	2700K   3000K   4000K   6000K
Beam	15°   24°   36°

CB TÜV



FIXTURE COLOR ■ BK □ WH

### OPTIONS

- 1 NON-DIM
- 2 0/1-10V
- 3 DALI
- 4 ZIGBEE

CASAMBI

Track Cylinder - D16

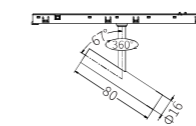

Track Cylinder - D20

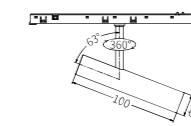

Track Cylinder - D30

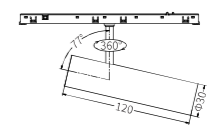

# Magnetic Lighting Solutions Gen2

Track Coin



## Track Coin Module

**LEDOS**  
LIGHTING SOLUTIONS

# Magnetic Lighting Solutions Gen2

Track Coin



### Track Coin - D50

<b>CRI</b>	Ra90
<b>Size</b>	Ø50 x 19 x 67mm
<b>LUMEN</b>	110lm/W
<b>Material</b>	Aluminum
<b>Power</b>	5W
<b>CCT</b>	2700K   3000K   4000K   6000K
<b>Beam</b>	15°   24°   36°

CB TÜV



**FIXTURE COLOR** ■ BK □ WH

### OPTIONS

- 1 NON-DIM
- 2 0/1-10V
- 3 DALI
- 4 ZIGBEE

CASAMBI

Track Coin - D50

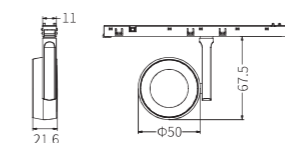

# Magnetic Lighting Solutions Gen2

Track CoinSQ



## Track CoinSQ Module

**LEDOS**  
LIGHTING SOLUTIONS

# Magnetic Lighting Solutions Gen2

Track CoinSQ



### Track CoinSQ - D62

<b>CRI</b>	Ra90
<b>Size</b>	Ø62 x 62 x 57mm
<b>LUMEN</b>	85lm/W
<b>Material</b>	Aluminum
<b>Power</b>	8W
<b>CCT</b>	2700K   3000K   4000K   6000K
<b>Beam</b>	15°   24°   36°

CB TÜV



### Track Coin - D88

<b>CRI</b>	Ra90
<b>Size</b>	Ø88 x 88 x 80.7mm
<b>LUMEN</b>	85lm/W
<b>Material</b>	Aluminum
<b>Power</b>	15W
<b>CCT</b>	2700K   3000K   4000K   6000K
<b>Beam</b>	15°   24°   36°

CB TÜV



**FIXTURE COLOR** ■ BK □ WH

#### OPTIONS

- 1 NON-DIM
- 2 0/1-10V
- 3 DALI
- 4 ZIGBEE

CASAMBI

Track CoinSQ - D62

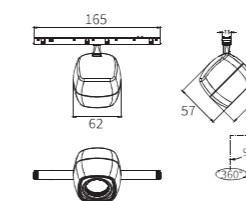

Track CoinSQ - D88

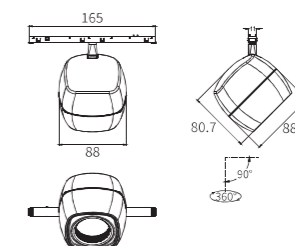

# Magnetic Lighting Solutions Gen2

Cylinder Downlight R Cell



## Cylinder Downlight R Cell Module

**LEDOS**  
LIGHTING SOLUTIONS

# Magnetic Lighting Solutions Gen2

Cylinder Downlight R Cell



### Cylinder Downlight R Cell - D47

CRI	Ra90
Size	Ø47.4 x 75mm
LUMEN	70lm/W
Material	Aluminum
Power	6W
CCT	2700K   3000K   4000K   6000K
Beam	26°   38°

CB TÜV

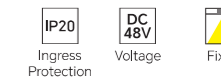

### Cylinder Downlight R Cell Integrated - D47

CRI	Ra90
Size	Ø47.4 x 75mm
LUMEN	70lm/W
Material	Aluminum
Power	6W
CCT	2700K   3000K   4000K   6000K
Beam	26°   38°

CB TÜV

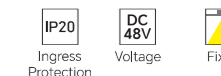

FIXTURE COLOR ■ BK □ WH

#### OPTIONS

- 1 NON-DIM
- 2 0/1-10V
- 3 DALI
- 4 ZIGBEE

CASAMBI

Cylinder Downlight Cell - D47

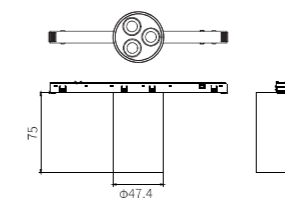

Cylinder Downlight Cell Integrated - D47

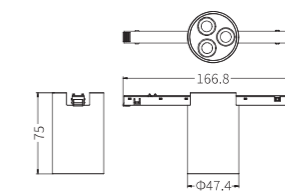

# Magnetic Lighting Solutions Gen2

Cylinder Downlight R Cell



## Cylinder Downlight R Cell Module

**LEDOS**  
LIGHTING SOLUTIONS

# Magnetic Lighting Solutions Gen2

Cylinder Downlight R Cell



Cylinder Downlight R Cell - D54	
CRI	Ra90
Size	Ø54.4 x 80mm
LUMEN	70lm/W
Material	Aluminum
Power	10W
CCT	2700K   3000K   4000K   6000K
Beam	26°   38°

CB TÜV



Cylinder Downlight R Cell Integrated - D54	
CRI	Ra90
Size	Ø54.4 x 80mm
LUMEN	70lm/W
Material	Aluminum
Power	10W
CCT	2700K   3000K   4000K   6000K
Beam	26°   38°

CB TÜV



FIXTURE COLOR ■ BK □ WH

**OPTIONS**

- 1 NON-DIM
- 2 0/1-10V
- 3 DALI
- 4 ZIGBEE

CASAMBI

Cylinder Downlight R Cell - D54

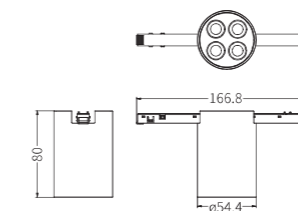

Cylinder Downlight R Cell Integrated - D54

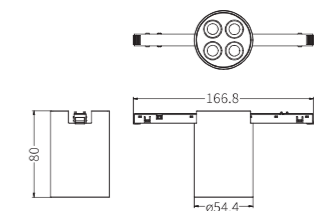

# Magnetic Lighting Solutions Gen2

Cylinder Downlight SQ Cell



## Cylinder Downlight SQ Cell Module

**LEDOS**  
LIGHTING SOLUTIONS

# Magnetic Lighting Solutions Gen2

Cylinder Downlight SQ Cell



### Cylinder Downlight SQ Cell - D44

<b>CRI</b>	Ra90
<b>Size</b>	Ø43.9 x 43.9 x 75mm
<b>LUMEN</b>	75lm/W
<b>Material</b>	Aluminum
<b>Power</b>	10W
<b>CCT</b>	2700K   3000K   4000K   6000K
<b>Beam</b>	26°   38°

CB TÜV



### Cylinder Downlight SQ Cell Integrated - D44

<b>CRI</b>	Ra90
<b>Size</b>	Ø43.9 x 43.9 x 75mm
<b>LUMEN</b>	75lm/W
<b>Material</b>	Aluminum
<b>Power</b>	10W
<b>CCT</b>	2700K   3000K   4000K   6000K
<b>Beam</b>	26°   38°

CB TÜV



FIXTURE COLOR ■ BK □ WH

#### OPTIONS

- 1 NON-DIM
- 2 0/1-10V
- 3 DALI
- 4 ZIGBEE

CASAMBI

Cylinder Downlight SQ Cell - D44

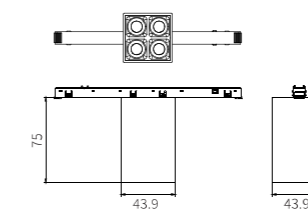

Cylinder Downlight SQ Cell Integrated - D44

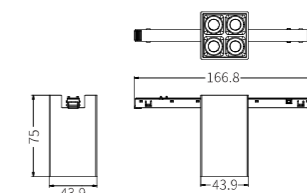

# Magnetic Lighting Solutions Gen2

Cylinder Downlight R Lens



## Cylinder Downlight R Lens Module

**LEDOS**  
LIGHTING SOLUTIONS

# Magnetic Lighting Solutions Gen2

Cylinder Downlight R Lens



### Cylinder Downlight R Lens - D47

<b>CRI</b>	Ra90
<b>Size</b>	Ø47.4 x 47.4 x 75mm
<b>LUMEN</b>	105lm/W
<b>Material</b>	Aluminum
<b>Power</b>	6W
<b>CCT</b>	2700K   3000K   4000K   6000K
<b>Beam</b>	18°   24°   36°   60°

CB TÜV



### Cylinder Downlight R Lens Integrated - D47

<b>CRI</b>	Ra90
<b>Size</b>	Ø47.4 x 75mm
<b>LUMEN</b>	105lm/W
<b>Material</b>	Aluminum
<b>Power</b>	6W
<b>CCT</b>	2700K   3000K   4000K   6000K
<b>Beam</b>	18°   24°   36°   60°

CB TÜV



FIXTURE COLOR ■ BK □ WH

#### OPTIONS

- 1 NON-DIM
- 2 0/1-10V
- 3 DALI
- 4 ZIGBEE

CASAMBI

Cylinder Downlight R Lens - D44

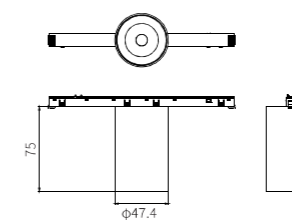

Cylinder Downlight R Lens Integrated - D44

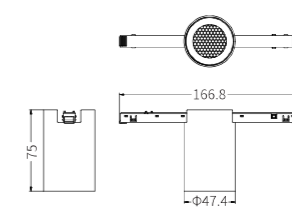

# Magnetic Lighting Solutions Gen2

Cylinder Downlight R Lens



## Cylinder Downlight R Lens Module

**LEDOS**  
LIGHTING SOLUTIONS

# Magnetic Lighting Solutions Gen2

Cylinder Downlight R Lens



### Cylinder Downlight R Lens - D54

<b>CRI</b>	Ra90
<b>Size</b>	Ø54.4 x 80mm
<b>LUMEN</b>	105lm/W
<b>Material</b>	Aluminum
<b>Power</b>	10W
<b>CCT</b>	2700K   3000K   4000K   6000K
<b>Beam</b>	18°   24°   36°   60°

CB TÜV



### Cylinder Downlight R Lens Integrated - D54

<b>CRI</b>	Ra90
<b>Size</b>	Ø54.4 x 80mm
<b>LUMEN</b>	105lm/W
<b>Material</b>	Aluminum
<b>Power</b>	10W
<b>CCT</b>	2700K   3000K   4000K   6000K
<b>Beam</b>	18°   24°   36°   60°

CB TÜV



FIXTURE COLOR ■ BK □ WH

#### OPTIONS

- 1 NON-DIM
- 2 0/1-10V
- 3 DALI
- 4 ZIGBEE

CASAMBI

Cylinder Downlight R Lens - D54

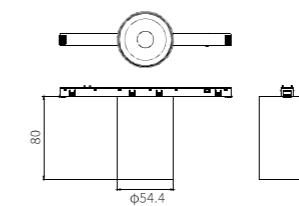

Cylinder Downlight R Lens Integrated - D54

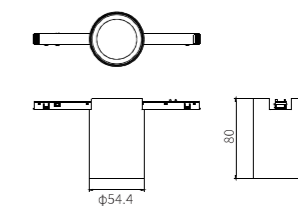

# Magnetic Lighting Solutions Gen2

Stick Pendant



Stick Pendant Module

**LEDOS**  
LIGHTING SOLUTIONS

# Magnetic Lighting Solutions Gen2

Stick Pendant



Stick Pendant - D20	
CRI	Ra90
Size	ø20 x 400mm
LUMEN	55lm/W
Material	Aluminum
Power	5W
CCT	2700K   3000K   4000K   6000K
Beam	15°   24°   36°

CB TÜV



FIXTURE COLOR ■ BK □ WH

- OPTIONS**
- 1 NON-DIM
  - 2 0/1-10V
  - 3 DALI
  - 4 ZIGBEE

CASAMBI

Stick Pendant - D20

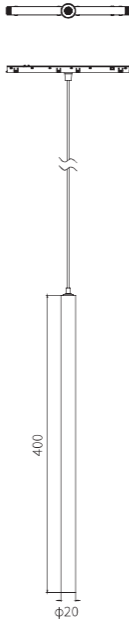

# Magnetic Lighting Solutions Gen2

Sticone Pendant



## Sticone Pendant Module

# LEDOS

LIGHTING SOLUTIONS

# Magnetic Lighting Solutions Gen2

Sticone Pendant



### Sticone Pendant - D70

<b>CRI</b>	Ra90
<b>Size</b>	Ø70 x 225mm
<b>LUMEN</b>	100lm/W
<b>Material</b>	Aluminum
<b>Power</b>	10W
<b>CCT</b>	2700K   3000K   4000K   6000K
<b>Beam</b>	15°   24°   36°

CB TÜV



**FIXTURE COLOR** ■ BK □ WH

### OPTIONS

- 1 NON-DIM
- 2 0/1-10V
- 3 DALI
- 4 ZIGBEE

CASAMBI

### Sticone Pendant - D20

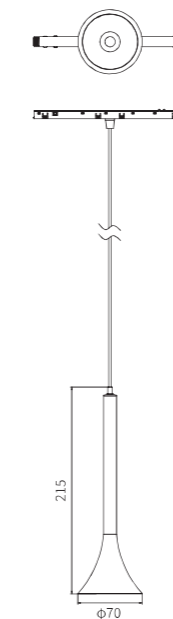

# Magnetic Lighting Solutions Gen2

LinearBlade Mesh



## LinearBlade Mesh Module

**LEDOS**  
LIGHTING SOLUTIONS

# Magnetic Lighting Solutions Gen2

LinearBlade Mesh



### LinearBlade Mesh - 300

<b>CRI</b>	Ra90
<b>Size</b>	Ø314.2 x 74.9 x 18.5mm
<b>LUMEN</b>	95lm/W
<b>Material</b>	Aluminum
<b>Power</b>	18W
<b>CCT</b>	2700K   3000K   4000K   6000K
<b>Beam</b>	60°   75°

CB TÜV



**FIXTURE COLOR** ■ BK □ WH

#### OPTIONS

- 1 NON-DIM
- 2 0/1-10V
- 3 DALI
- 4 ZIGBEE

CASAMBI

#### LinearBlade Mesh - 300

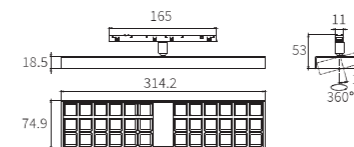

# Magnetic Lighting Solutions Gen2

BladeEdge R



## BladeEdge R Module

**LEDOS**  
LIGHTING SOLUTIONS

# Magnetic Lighting Solutions Gen2

BladeEdge R



### BladeEdge R - 165

CRI	Ra90
Size	Ø165 x 39.5mm
LUMEN	75lm/W
Material	Aluminum
Power	10W
CCT	2700K   3000K   4000K   6000K

CB TÜV



FIXTURE COLOR  BK  WH

#### OPTIONS

- 1 NON-DIM
- 2 0/1-10V
- 3 DALI
- 4 ZIGBEE

CASAMBI

BladeEdge R - 165

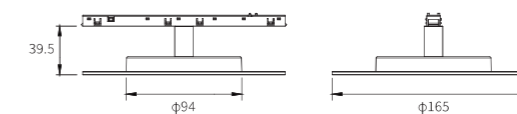

## Magnetic Lighting Solutions Gen2

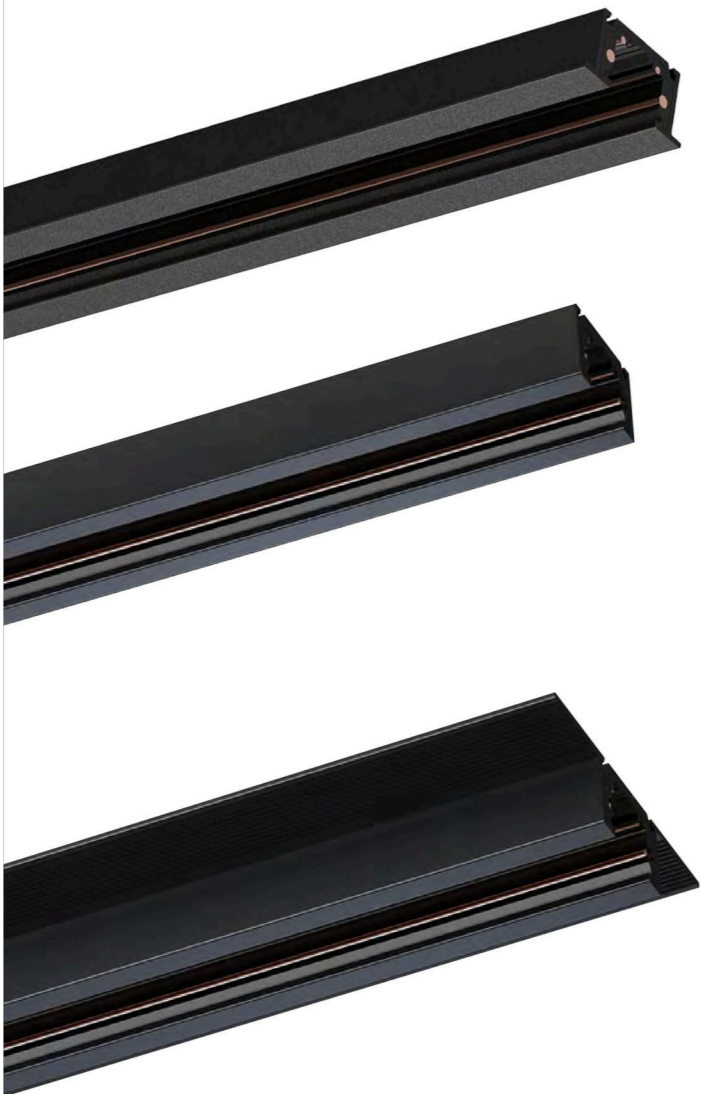

## Magnetic Lighting Solutions Gen2 Accessories

**LEDOS**  
LIGHTING SOLUTIONS

## Magnetic Lighting Solutions Gen2



**Magnetic Track Recessed Trimless**

<b>Size</b>	49.4 x 12.1mm
<b>Material</b>	Aluminum

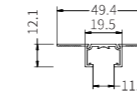

**Magnetic Track Surface / Suspended**

<b>Size</b>	19.5 x 12.1mm
<b>Material</b>	Aluminum

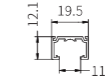

**Magnetic Track Recessed Collar**

<b>Size</b>	25.5 x 14.3mm
<b>Material</b>	Aluminum



**Butterfly Clips Recessed**

<b>Size</b>	40.5 x 30 x 37.7mm
<b>Material</b>	Aluminum

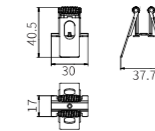

**Magnetic Track Driver 100W**

<b>Size</b>	235.5 x 18 x 31.1mm
<b>Material</b>	Aluminum

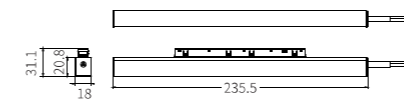

**Magnetic Track Driver 150W**

<b>Size</b>	305.5 x 18 x 31.1mm
<b>Material</b>	Aluminum

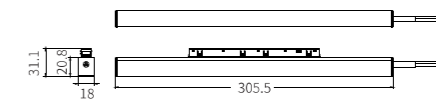

FIXTURE COLOR ■ BK □ WH

## Magnetic Lighting Solutions Gen2

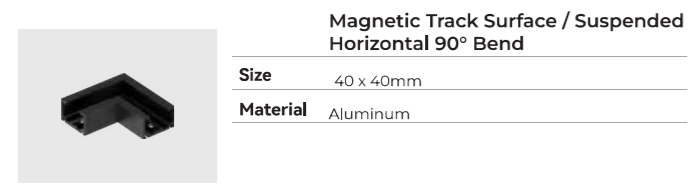

**Magnetic Track Surface / Suspended Horizontal 90° Bend**

**Size** 40 x 40mm  
**Material** Aluminum

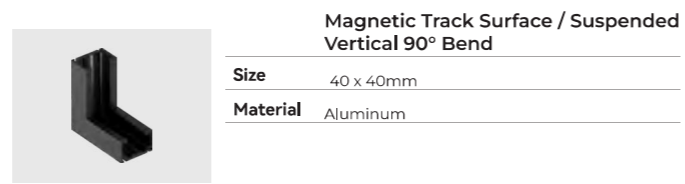
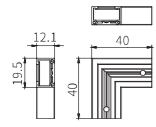

**Magnetic Track Surface / Suspended Vertical 90° Bend**

**Size** 40 x 40mm  
**Material** Aluminum

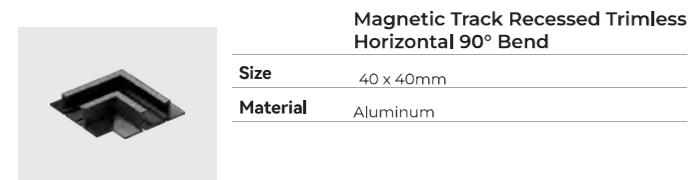
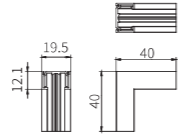

**Magnetic Track Recessed Trimless Horizontal 90° Bend**

**Size** 40 x 40mm  
**Material** Aluminum

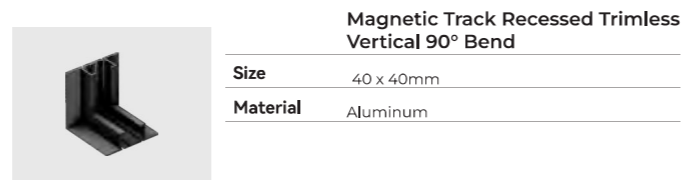
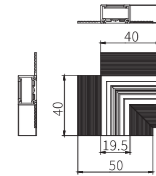

**Magnetic Track Recessed Trimless Vertical 90° Bend**

**Size** 40 x 40mm  
**Material** Aluminum

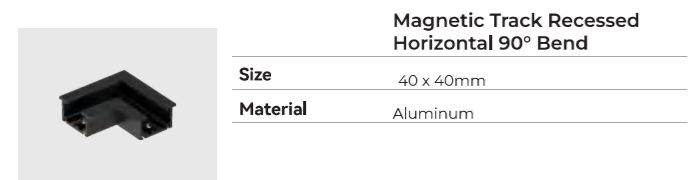
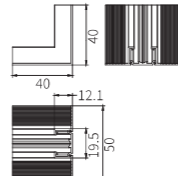

**Magnetic Track Recessed Horizontal 90° Bend**

**Size** 40 x 40mm  
**Material** Aluminum

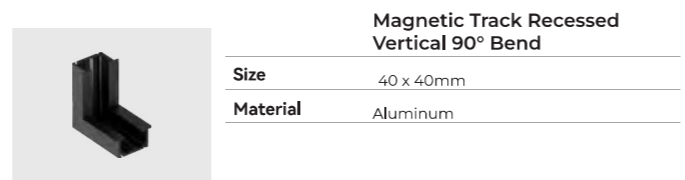
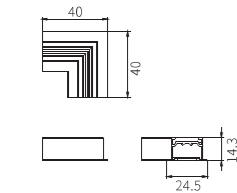

**Magnetic Track Recessed Vertical 90° Bend**

**Size** 40 x 40mm  
**Material** Aluminum

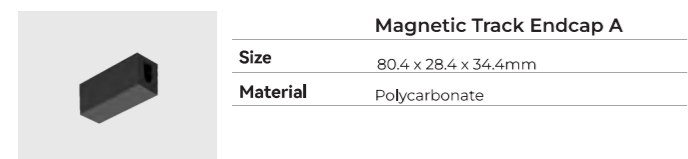
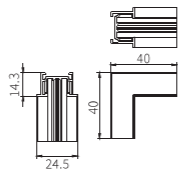

**Magnetic Track Endcap A**

**Size** 80.4 x 28.4 x 34.4mm  
**Material** Polycarbonate

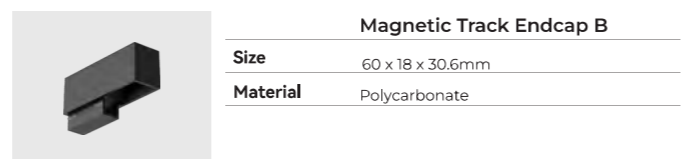
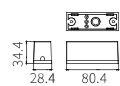

**Magnetic Track Endcap B**

**Size** 60 x 18 x 30.6mm  
**Material** Polycarbonate

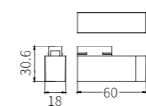

FIXTURE COLOR ■ BK □ WH

## Magnetic Lighting Solutions Gen2

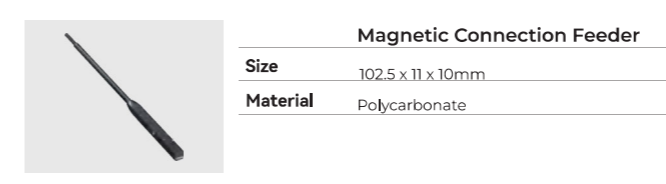

**Magnetic Connection Feeder**

**Size** 102.5 x 11 x 10mm  
**Material** Polycarbonate

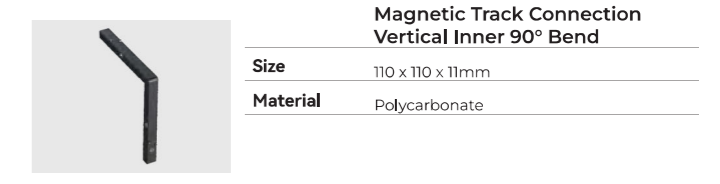
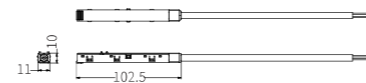

**Magnetic Track Connection Vertical Inner 90° Bend**

**Size** 110 x 110 x 11mm  
**Material** Polycarbonate

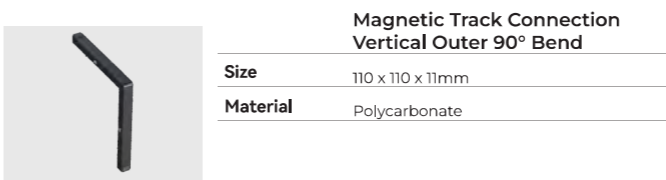
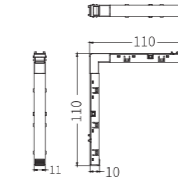

**Magnetic Track Connection Vertical Outer 90° Bend**

**Size** 110 x 110 x 11mm  
**Material** Polycarbonate

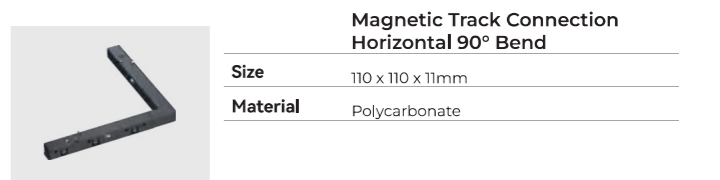
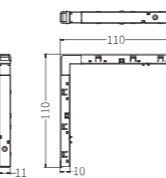

**Magnetic Track Connection Horizontal 90° Bend**

**Size** 110 x 110 x 11mm  
**Material** Polycarbonate

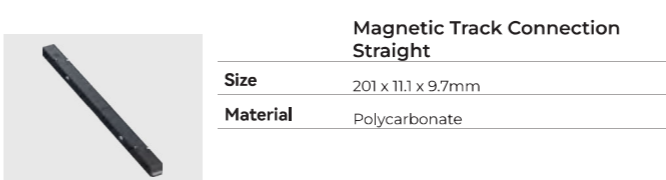
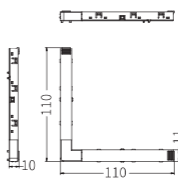

**Magnetic Track Connection Straight**

**Size** 201 x 11.1 x 9.7mm  
**Material** Polycarbonate

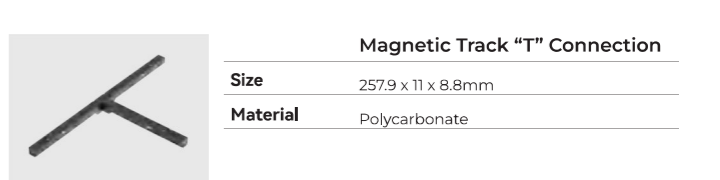

**Magnetic Track "T" Connection**

**Size** 257.9 x 11 x 8.8mm  
**Material** Polycarbonate

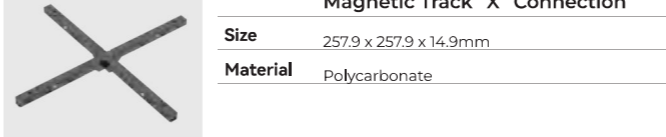
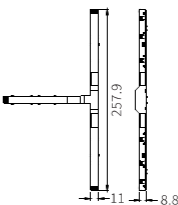

**Magnetic Track "X" Connection**

**Size** 257.9 x 257.9 x 14.9mm  
**Material** Polycarbonate

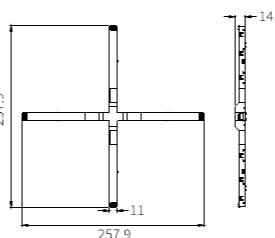

FIXTURE COLOR ■ BK □ WH